

WHITEFISH LAKE

LYFORD STREET

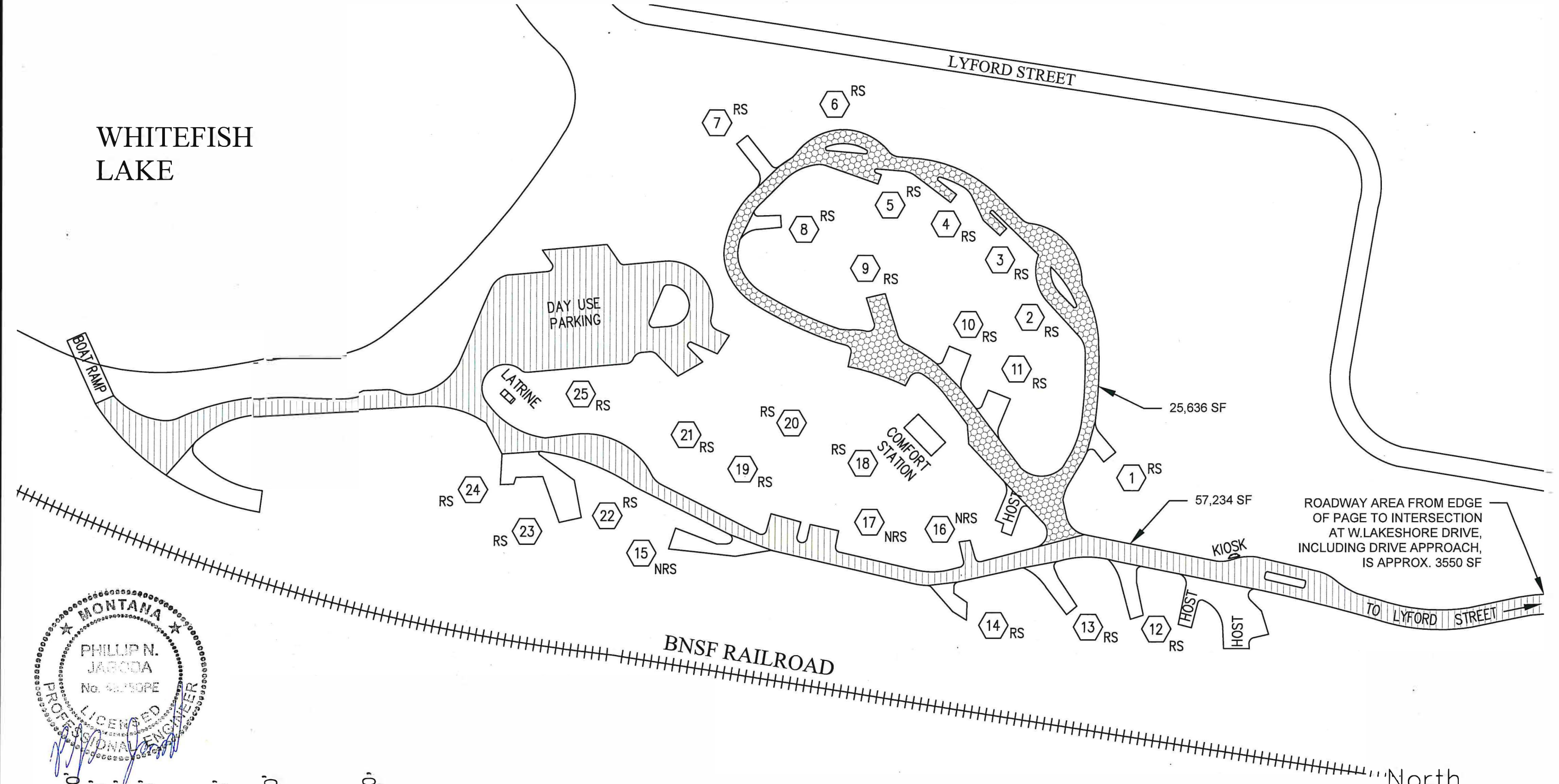

ROADWAY AREA FROM EDGE OF PAGE TO INTERSECTION AT W.LAKESHORE DRIVE, INCLUDING DRIVE APPROACH, IS APPROX. 3550 SF

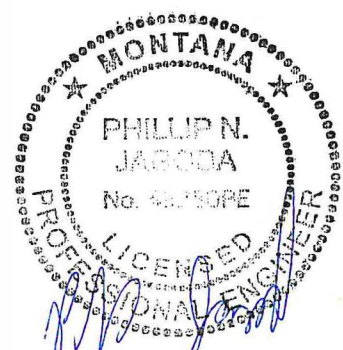

Campground Site Plan

SCALE : 1" = 100'

DRAWN BY: K. Gill	DATE: 1/31/2022	APPROVED BY:	DATE:	APPROVED BY:	DATE:
CHECKED BY:	DATE:	APPROVED BY:	DATE:	APPROVED BY:	DATE:



Whitefish Lake State Park
2023 Pavement Chip Seal



SHEET: 1 of 1