

**FUTURE FISHERIES IMPROVEMENT PROGRAM GRANT APPLICATION***All sections must be addressed, or the application will be considered invalid***I. APPLICANT INFORMATION**

A. Applicant Name: \_\_\_\_\_

Mailing Address: \_\_\_\_\_

City: \_\_\_\_\_ State: \_\_\_\_\_ Zip: \_\_\_\_\_

Telephone: \_\_\_\_\_ E-mail: \_\_\_\_\_

B. Contact Person (if different than applicant): \_\_\_\_\_

Address: \_\_\_\_\_

City: \_\_\_\_\_ State: \_\_\_\_\_ Zip: \_\_\_\_\_

Telephone: \_\_\_\_\_ E-mail: \_\_\_\_\_

C. Landowner and/or Lessee Name (if different than applicant): \_\_\_\_\_

Mailing Address: \_\_\_\_\_

City: \_\_\_\_\_ State: \_\_\_\_\_ Zip: \_\_\_\_\_

Telephone: \_\_\_\_\_ E-mail: \_\_\_\_\_

**II. PROJECT INFORMATION**

A. Project Name: \_\_\_\_\_

River, stream, or lake: \_\_\_\_\_

Location: Township: \_\_\_\_\_ Range: \_\_\_\_\_ Section: \_\_\_\_\_

Latitude: \_\_\_\_\_ Longitude: \_\_\_\_\_ *Within project (decimal degrees)*

County: \_\_\_\_\_

B. Purpose of Project: *(high level, focus on why the project is important)*

- C. Brief Project Description (attach additional information to end of application). Please include the anticipated construction schedule:

- D. What was the cause of habitat degradation and how will the project correct the cause?

- E. Length of stream or size of lake that will be treated (project extent): \_\_\_\_\_  
 Length/size of impact, if larger than project extent (e.g., stream miles opened): \_\_\_\_\_
- F. Project Budget Summary:
- |   |           |       |
|---|-----------|-------|
| <b>Grant Request (Dollars):</b>   | <b>\$</b> | _____ |
| Matching Dollars:   | <b>\$</b> | _____ |
| Matching In-Kind Services:*   | <b>\$</b> | _____ |
| <small>*salaries of government employees <u>are not</u> considered matching contributions</small> |           |       |
| Other Contributions (not used as match)   | <b>\$</b> | _____ |
| <b>Total Project Cost:</b>  | <b>\$</b> | _____ |
- G. Attach itemized (line item) budget – see *budget template*
- H. Attach project location map(s) that include:
- ☐ Extent of the project, including context (relation to major landmark or town)
  - ☐ Indication of public and private property
  - ☐ Riparian buffer locations and widths (if applicable) and grazing locations
- I. Attach project plans:
- ☐ Detailed sketches or plan views with the location and proposed restoration
  - ☐ Pre-project photographs (GPS location strongly recommended)
  - ☐ If water leasing or water salvage is involved, attach a supplemental questionnaire (<https://myfwp.mt.gov/getRepositoryFile?objectID=36110>)
- J. Attach letters or statements of support (e.g., landowner consent, community or public support). For FWP statement, attach provided template. List any other project partners:
- 

### III. MAINTENANCE AND MONITORING (attach additional information to end of application):

- A. A 20-year maintenance commitment is required\*. Please confirm that you will ensure this protection and describe your approach. Attach any relevant maintenance plans. Yes ☐ No ☐
- \*If it is a water leasing project, describe the length of the agreement.

- B. Will grazing be part of or adjacent to the project? If so, describe or attach land management plans, including short term and long term grazing regimes. If the landowner is not the applicant, please describe their involvement in the project. *If you want assistance with grazing plan development, note your need.*

- C. Will the project be monitored to determine if goals were met? If so, what are the short-term and long-term plans to assess benefits and lessons learned? Were pre-project data collected? Will monitoring information be shared with FWP?

**IV. PROJECT BENEFITS** (attach additional information to end of application):

- A. What species of fish will benefit from this project?

- B. How will the project protect or enhance wild fish habitat?

- C. What is the expected improvement to fish populations, both short term and long term? How might the project translate to angler success?

- D. Will the project increase public fishing opportunity for wild fish and, if so, how? Is public fishing allowed onsite? Is it allowed by permission? If not, describe how the public would benefit.

- E. Aside from angling, what local or large-scale public benefits will be realized from this project?

- F. Will the project interfere with water or property rights of adjacent landowners? (explain):

- G. Will the project result in the development of commercial recreational use on the site (including paid access)? Explain:

- H. Is this project associated with the reclamation of past mining activity?

**Each approved project applicant must enter into a written agreement with Montana Fish, Wildlife & Parks specifying terms and duration of the project. The applicant must obtain all applicable permits prior to project construction. A competitive bid process must be followed when using State funds.**

**V. AUTHORIZING STATEMENT**

I (we) hereby declare that the information and all statements to this application are true, complete, and accurate to the best of my (our) knowledge and that the project or activity complies with rules of the Future Fisheries Improvement Program.

Applicant Signature:  Date: \_\_\_\_\_

**Submittal: Applications must be signed and received on or before November 15 and May 15 to be considered for the subsequent funding period.** Late or incomplete applications will be rejected.

Mail to: FWP Future Fisheries Fish Habitat Bureau PO Box 200701 Helena, MT 59620-0701	Email: Future Fisheries Coordinator <a href="mailto:FWPFFIP@mt.gov">FWPFFIP@mt.gov</a> (electronic submissions must be signed) For files over 10MB, use <a href="https://transfer.mt.gov">https://transfer.mt.gov</a> and send to <a href="mailto:mmcgree@mt.gov">mmcgree@mt.gov</a>
--	--

# BUDGET TEMPLATE SHEET FOR FUTURE FISHERIES PROGRAM APPLICATIONS

Both tables MUST be completed appropriately or the application will be invalid. Please see the example budget sheet for clarification.

PROJECT COSTS					GRANT REQUEST AND FUNDING			
Work Items (Itemize by Category)	Number of Units	Unit Description*	Cost/Unit	Total Cost	FUTURE FISHERIES REQUEST	Matching Contributions (Cash or In-Kind)***	Other Contributions (Funds not used as match)	Total Funding
<i>*Units = feet, hours, cubic yards, etc. Do not use lump sum unless necessary.</i>								
<b>Personnel</b>								
Survey				\$ -				\$ -
Design				\$ -				\$ -
Engineering				\$ -				\$ -
Permitting				\$ -				\$ -
Oversight				\$ -				\$ -
Maintenance**				\$ -				\$ -
			Sub-Total	\$ -	\$ -	\$ -	\$ -	\$ -
<b>Travel</b>								
Mileage				\$ -				\$ -
Per diem				\$ -				\$ -
			Sub-Total	\$ -		\$ -	\$ -	\$ -
<b>Construction Materials</b>								
Fencing	3960	foot	\$3.31	\$ 13,107.60	9,107.60	1,000.00		\$ 10,107.60
Watering Facility	1000	gallon	\$4.27	\$ 4,270.00	2,770.00	500.00		\$ 3,270.00
Livestock Pipeline	1000	foot	\$2.35	\$ 2,350.00	1,350.00	500.00		\$ 1,850.00
Pumping Plant	1	kilowatt	\$6,996.54	\$ 6,996.54	4,496.54	1,000.00		\$ 5,496.54
Structure for Water Control	1	each	\$11,252.30	\$ 11,252.30	2,276.86	6,975.44		\$ 9,252.30
				\$ -				\$ -
				\$ -				\$ -
				\$ -				\$ -
			Sub-Total	\$ 37,976.44	\$ 20,001.00	\$ 9,975.44	\$ -	\$ 29,976.44
<b>Equipment, Labor, and Mobilization</b>								
Miscellaneous Labor				\$ -		8,000.00		\$ 8,000.00
				\$ -				\$ -
				\$ -				\$ -
				\$ -				\$ -
				\$ -				\$ -
				\$ -				\$ -
				\$ -				\$ -
				\$ -				\$ -
				\$ -				\$ -
				\$ -				\$ -
			Sub-Total	\$ -	\$ -	\$ 8,000.00	\$ -	\$ 8,000.00
<b>OVERALL TOTALS</b>					\$ 37,976.44	\$ 20,001.00	\$ 17,975.44	\$ 37,976.44

OTHER REQUIREMENTS:

## BUDGET TEMPLATE SHEET FOR FUTURE FISHERIES PROGRAM APPLICATIONS

\*\*For projects that include a maintenance request, it cannot exceed 10% of the total project cost.

\*\*\*Match can include in-kind materials or labor. Justification for in-kind labor (e.g. hourly rates used) can be noted below. Do not use government salaries as match.

Additional budget detail: MCSC Time \$45.57/hour

APPLICATION MATCHING CONTRIBUTIONS				
Total should equal match listed above; do not include requested funds				
CONTRIBUTOR	IN-KIND	CASH	TOTAL	Secured? (Y/N)
Applicant (Admin work @ \$45.57/hr)	\$ 5,000.00	\$ -	\$ 5,000.00	Y
Fish, Wildlife, and Parks: Smith River Corridor Enhancement Fund	\$ -	\$ 3,000.00	\$ 3,000.00	N
Meagher County Conservation District (319 funds)	\$ -	\$ 3,000.00	\$ 3,000.00	N
Montana Department of Environmental Quality	\$ -	\$ 4,975.44	\$ 4,975.44	N
Applicant Matching	\$ -	\$ 2,000.00	\$ 2,000.00	N
	\$ -	\$ -	\$ -	
	\$ -	\$ -	\$ -	
	\$ -	\$ -	\$ -	
TOTALS	\$ 5,000.00	\$ 12,975.44	\$ 17,975.44	

OTHER CONTRIBUTIONS				
Total should equal other contributions listed above; these are funds not specically matched to the Future Fisheries application				
CONTRIBUTOR	IN-KIND	CASH	TOTAL	Secured? (Y/N)
	\$ -	\$ -	\$ -	
	\$ -	\$ -	\$ -	
	\$ -	\$ -	\$ -	
	\$ -	\$ -	\$ -	
	\$ -	\$ -	\$ -	
	\$ -	\$ -	\$ -	
	\$ -	\$ -	\$ -	
	\$ -	\$ -	\$ -	
TOTALS	\$ -	\$ -	\$ -	

# MONTANA FISH

## Future Fisheries Improvement Program

### *Appendix: FWP Statement*

Project Title: Smith River Riparian Habitat Enhancement

Please describe the potential impact of the project, including the priorities of the Fisheries Division and the importance to Montana's anglers.

Improvement of riparian habitat, exclusion of livestock, and reduction of sediment input will improve fish habitat and water quality in the Smith River, resulting in short-term and long-term benefits to Smith River anglers. This is in agreement with the goals of the Smith River Watershed Restoration Plan which include improving water quality, water quantity, riparian habitat, and stream habitat. This is also in agreement with the goals stated in the Statewide Management Plan. Specific benefits may include overhanging bank fish habitat, increased spawning/recruitment potential, reduced summer water temperatures.

Name of FWP Biologist Adam Geik Date: 5/14/2025

*Please attach to the FFIP application and materials and submit according to listed deadlines.*



Montana Fish, Wildlife & Parks  
Future Fisheries Improvement Program  
PO Box 200701  
Helena, MT 59620-0701

To Whom It May Concern:

As the current grazing lessee of the state trust land along the Smith River in Meagher County, I am writing on behalf of Keyhole Cattle Co. in support of the riparian restoration project proposed by the Meagher County Stewardship Council.

This project builds on recent work already completed in this reach, including willow planting conducted in 2024 through a DEQ watershed grant. We fully support the addition of riparian fencing and off-stream water development infrastructure to protect those plantings, reduce streambank erosion, and improve long-term land health. We believe these improvements will not only benefit water quality and fish habitat but will also support our grazing operation by providing more reliable livestock water and helping to protect infrastructure during flood events and seasonal channel shifts.

Keyhole Cattle Co. is committed to being a good steward of this landscape and is willing to coordinate closely with the Stewardship Council and DNRC to support ongoing maintenance of the project and ensure it remains compatible with future grazing rotations. We understand this project aligns with the goals of the Smith River Watershed Restoration Plan, and we're proud to be a part of it.

Thank you for considering this important work.

Sincerely, ~

 5/9/2025

Michael Dupea  
Keyhole Cattle Co.  
406-547-4181

Meagher County Conservation District  
PO Box 589  
White Sulphur Springs, MT 59645  
406-547-3633  
[meaghercocd@itstriangle.com](mailto:meaghercocd@itstriangle.com)

May 13, 2025

FWP Future Fisheries  
Fish Habitat Bureau  
PO Box 200701  
Helena, MT 59620-0701

**RE: LETTER OF SUPPORT FOR MEAGHER COUNTY STEWARDSHIP COUNCIL'S  
APPLICATION FOR FUTURE FISHERIES FUNDING  
SMITH RIVER RIPARIAN HABITAT ENHANCEMENT PROJECT**

Dear Future Fisheries Coordinator:

The Meagher County Conservation District supports the Meagher County Stewardship Council's (MCSC) application for Future Fisheries grant funding for the Smith River Riparian Habitat Enhancement Project.

The project is a voluntary installation of livestock exclusion fencing along 0.75 miles of the Smith River and a potential new offstream stockwater source. This project protects a willow planting project DEQ helped fund, protects water quality along with the continued operation of a Montana agricultural operation, and supports the partnership of the Meagher County Stewardship Council.

Conservation Districts have been entrusted by the state with mandated activities such as implementation of the 310 Law, water reservations, stream access portage routes, county planning board participation, local Total Maximum Daily Load (TMDL) consultation, and also serve as the local point of contact for numerous federal programs. Conservation districts sponsor many stream restoration projects, conduct landowner workshops, produce and distribute informational and educational materials, and hold demonstrations and tours of innovative riparian management techniques and projects. This project complements the ongoing work of MCCD and partnership between the MCSC and the MCCD.

Please fully fund the Meagher County Stewardship Council's Future Fisheries grant request.

Sincerely,

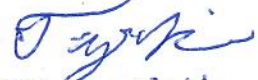

Tyson Hill  
Board Chair

Meagher County Conservation District



May 13, 2025

FWP Future Fisheries  
Fish Habitat Bureau  
PO Box 200701  
Helena, MT 59620-0701

**RE: LETTER OF SUPPORT FOR MEAGHER COUNTY STEWARDSHIP COUNCIL'S APPLICATION FOR FUTURE FISHERIES FUNDING FOR THE SMITH RIVER RIPARIAN HABITAT ENHANCEMENT PROJECT**

Dear Future Fisheries Coordinator:

The Montana Department of Environmental Quality (DEQ) supports the Meagher County Stewardship Council's (MCSC) application for Future Fisheries grant funding for the Smith River Riparian Habitat Enhancement Project. This project would implement water quality improvement recommendations in the newly completed Smith River Watershed Restoration Plan and address several causes of impairment identified on Montana's List of Impaired Waters (sometimes referred to as the 303d list). It would reduce phosphorus loading that is currently contributing to an impairment of aquatic life beneficial uses and E. Coli that is contributing to impairment of primary contact recreation beneficial uses.

The project calls for MCSC to install livestock exclusion fencing along 0.75 miles of the Smith River, and potentially a new, off-stream watering source for livestock. This would protect water quality while still maintaining the viability of a local Montana livestock operation. The riparian fencing would also help protect a willow planting project DEQ helped fund and support the ongoing engagement of the Meagher County Steward Council in water quality improvement projects.

Please fully fund the Meagher County Stewardship Council's Future Fisheries grant request.

Sincerely,

A handwritten signature in blue ink that reads "Andy Ulven".

Andy Ulven, Chief  
DEQ Water Quality Planning Bureau



May 12, 2025

Montana Fish, Wildlife & Parks  
Future Fisheries Improvement Program  
PO Box 200701  
Helena, MT 59620-0701

To Whom It May Concern:

As president of the Montana Trout Foundation, I'm writing on behalf of our organization in support of the riparian restoration project proposed by the Meagher County Stewardship Council.

The Montana Trout Foundation is a non-political, non-partisan 501c3 non-profit organization, and our sole purpose is to preserve and enhance wild trout resources in the state. We were founded in 1972 by Bud Lilly and Dick McGuire, who wanted to create an organization that could help fund projects that were specific to Montana. We operate as an all-volunteer board, and run a small grant program that funds projects on an annual basis.

As we understand it, the proposed project builds on recent work already completed in a section of the Smith, including willow planting conducted in 2024 through a DEQ watershed grant. We fully support the addition of riparian fencing and off-stream water development infrastructure to protect those plantings, reduce streambank erosion, and improve long-term land health. We believe these improvements will not only benefit water quality and fish habitat, but also improve fish numbers in the Smith, which will improve the quality of overall fishing — key to our mission.

Thank you for your consideration of this worthy project.

David A. Thompson  
President, MT Trout Foundation

## Measure Distance



Planar

Miles

Result



### Distance

Segment (mi)	Path (mi)	Sum (mi)
0.07	0.43	0.43
0.07		
0.12		
0.07		
0.03		
0.03		
0.03		

Path Net Bearing: 218°

Path Net Distance: 0.29 mi

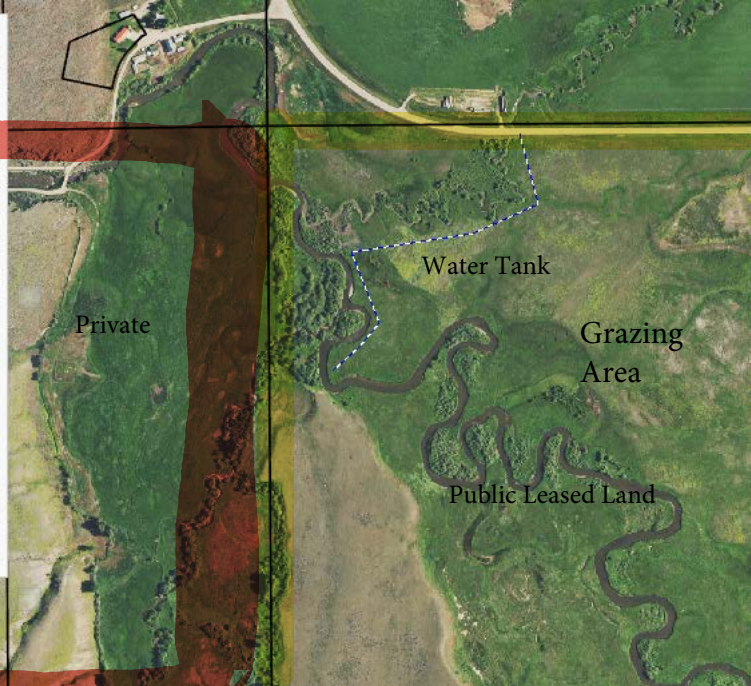



36







Tax Year: 2025

Scale: 1:25255.42 Basemap: Cadastral Application Base Map

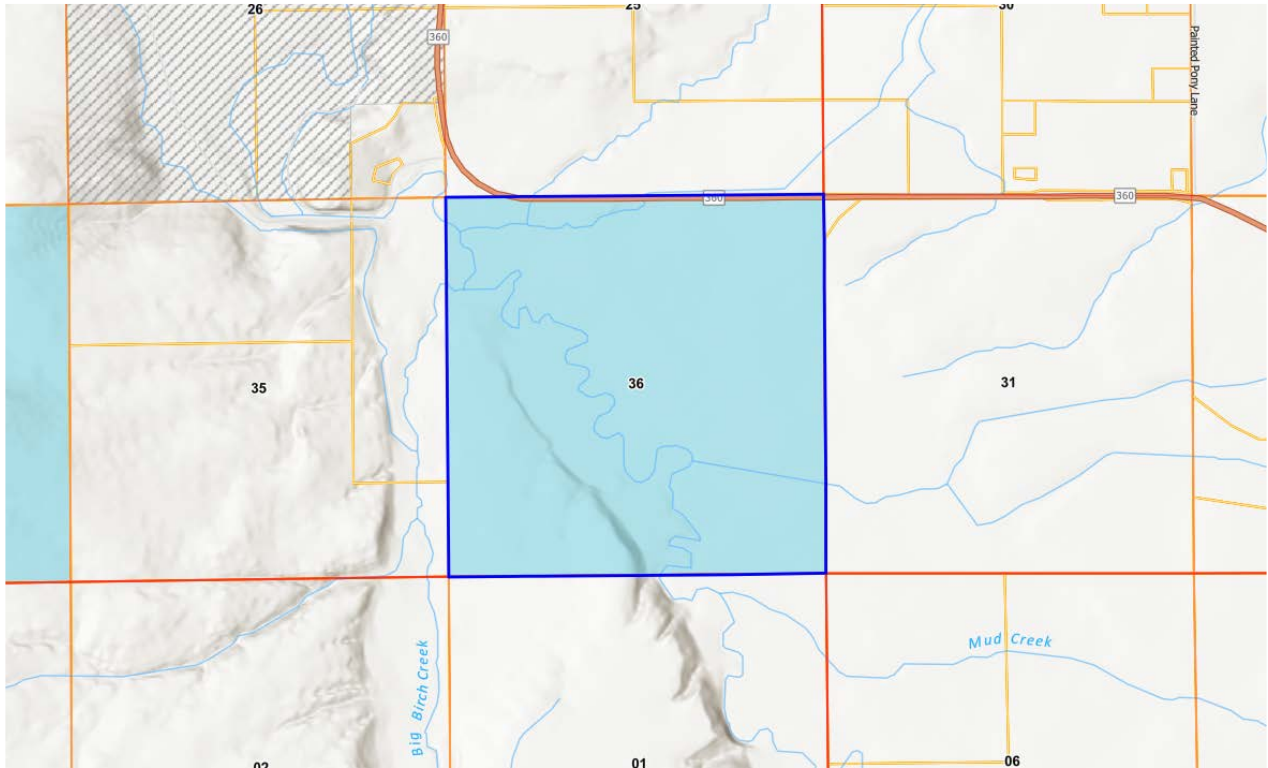

## Summary

### Primary Information

Property Category: RP

Subcategory: Government Property

Geocode: 47-1897-36-1-01-01-0000

Assessment Code: 00EX800301

#### Primary Owner:

STATE OF MONTANA  
1625 11TH AVE  
HELENA, MT 59601-4640  
Note: See Owners section for all owners

#### Property Address:

Certificate of Survey:

Legal Description: S36, T10 N, R05 E, ALL - 649.466 ACS

Last Modified: 4/26/2025 5:30:16 AM



# Cadastral Property Report

Tax Year: 2025

## General Property Information

Neighborhood: 247.001	Property Type: Exempt Property
Living Units: 0	Levy District: 47-1569-80
Zoning:	Ownership: 100
LinkedProperty: No linked properties exist for this property	
Exemptions: No exemptions exist for this property	
Condo Ownership:	Limited: 0
General: 0	

## Property Factors

Topography: n/a	Fronting: n/a
Utilities: n/a	Parking Type: n/a
Access: n/a	Parking Quantity: n/a
Location: n/a	Parking Proximity: n/a

## Land Summary

Land Type:	Acres:	Value:
Grazing	0	0
Fallow	0	0
Irrigated	0	0
Continuous Crop		
Wild Hay	0	0
Farmsite	0	0
ROW	0	0
NonQual Land	0	0
Total Ag Land	649.466	0
Total Forest Land	0	0
Total Market Land	0	0

## Deed Information

Deed Date	Book	Page	Recorded Date	Document Number	Document Type
-----------	------	------	---------------	-----------------	---------------

## Owners

### Party #1

Default Information:	STATE OF MONTANA 1625 11TH AVE HELENA, MT 59601-4640
Ownership %:	100
Primary Owner:	Yes
Interest Type:	Conversion
Last Modified:	12/16/2007 21:38:50 PM

Tax Year: 2025

## Party #2

Default Information:	STATE LANDS 1625 11TH AVE HELENA, MT 59601-4640
Ownership %:	100
Primary Owner:	Yes
Interest Type:	Conversion
Last Modified:	12/16/2007 21:38:50 PM

## Appraisals

### Appraisal History

Tax Year	Land Value	Building Value	Total Value	Method
2024	97111	0	97111	COST
2023	97111	0	97111	COST
2022	92940	0	92940	COST

## Market Land

No market land exists for this parcel

## Dwellings

No dwellings exist for this parcel

## Other Buildings

No other buildings exist for this parcel

## Commercial

Tax Year: 2025

No commercial buildings exist for this parcel

## Ag/Forest Land

### Ag/Forest Land Item #1

Acre Type: G - Grazing  
Class Code: 1651

Irrigation Type: n/a  
Timber Zone: n/a

#### Productivity

Quantity: 0.126  
Units: AUM/Acre

Commodity: Grazing Fee

#### Valuation

Acres: 26.19  
Value: n/a

Per Acre Value: n/a

### Ag/Forest Land Item #2

Acre Type: G - Grazing  
Class Code: 1651

Irrigation Type: n/a  
Timber Zone: n/a

#### Productivity

Quantity: 0.137  
Units: AUM/Acre

Commodity: Grazing Fee

#### Valuation

Acres: 14.269  
Value: n/a

Per Acre Value: n/a

### Ag/Forest Land Item #3

Acre Type: G - Grazing  
Class Code: 1651

Irrigation Type: n/a  
Timber Zone: n/a

#### Productivity

Quantity: 0.181  
Units: AUM/Acre

Commodity: Grazing Fee

#### Valuation

Acres: 16.708  
Value: n/a

Per Acre Value: n/a

Tax Year: 2025

## Ag/Forest Land Item #4

Acre Type: G - Grazing  
Class Code: 1651

Irrigation Type: n/a  
Timber Zone: n/a

### Productivity

Quantity: 0.189  
Units: AUM/Acre

Commodity: Grazing Fee

### Valuation

Acres: 89.336  
Value: n/a

Per Acre Value: n/a

## Ag/Forest Land Item #5

Acre Type: G - Grazing  
Class Code: 1651

Irrigation Type: n/a  
Timber Zone: n/a

### Productivity

Quantity: 0.22  
Units: AUM/Acre

Commodity: Grazing Fee

### Valuation

Acres: 2.367  
Value: n/a

Per Acre Value: n/a

## Ag/Forest Land Item #6

Acre Type: G - Grazing  
Class Code: 1651

Irrigation Type: n/a  
Timber Zone: n/a

### Productivity

Quantity: 0.29  
Units: AUM/Acre

Commodity: Grazing Fee

### Valuation

Acres: 12.986  
Value: n/a

Per Acre Value: n/a

## Ag/Forest Land Item #7

Acre Type: G - Grazing  
Class Code: 1651

Irrigation Type: n/a  
Timber Zone: n/a

### Productivity

Quantity: 0.66  
Units: AUM/Acre

Commodity: Grazing Fee

### Valuation

Acres: 139.783  
Value: n/a

Per Acre Value: n/a

Tax Year: 2025

## Ag/Forest Land Item #8

Acre Type: G - Grazing  
Class Code: 1651

Irrigation Type: n/a  
Timber Zone: n/a

### Productivity

Quantity: 0.728  
Units: AUM/Acre

Commodity: Grazing Fee

### Valuation

Acres: 255.461  
Value: n/a

Per Acre Value: n/a

## Ag/Forest Land Item #9

Acre Type: G - Grazing  
Class Code: 1651

Irrigation Type: n/a  
Timber Zone: n/a

### Productivity

Quantity: 0.738  
Units: AUM/Acre

Commodity: Grazing Fee

### Valuation

Acres: 44.871  
Value: n/a

Per Acre Value: n/a

## Ag/Forest Land Item #10

Acre Type: G - Grazing  
Class Code: 1651

Irrigation Type: n/a  
Timber Zone: n/a

### Productivity

Quantity: 0.753  
Units: AUM/Acre

Commodity: Grazing Fee

### Valuation

Acres: 9.991  
Value: n/a

Per Acre Value: n/a

## Ag/Forest Land Item #11

Acre Type: G - Grazing  
Class Code: 1651

Irrigation Type: n/a  
Timber Zone: n/a

### Productivity

Quantity: 0.108  
Units: AUM/Acre

Commodity: Grazing Fee

### Valuation

Acres: 12.924  
Value: n/a

Per Acre Value: n/a

Tax Year: 2025

## Ag/Forest Land Item #12

Acre Type: G - Grazing  
Class Code: 1651

Irrigation Type: n/a  
Timber Zone: n/a

### Productivity

Quantity: 0.116  
Units: AUM/Acre

Commodity: Grazing Fee

### Valuation

Acres: 11.972  
Value: n/a

Per Acre Value: n/a

## Ag/Forest Land Item #13

Acre Type: G - Grazing  
Class Code: 1651

Irrigation Type: n/a  
Timber Zone: n/a

### Productivity

Quantity: 0.122  
Units: AUM/Acre

Commodity: Grazing Fee

### Valuation

Acres: 12.608  
Value: n/a

Per Acre Value: n/a

## Easements

No easements exist for this parcel

## Disclaimer

The Montana State Library (MSL) provides this product/service for informational purposes only. MSL did not produce it for, nor is it suitable for legal, engineering, or surveying purposes. Data from disparate sources may not be in vertical alignment. Consumers of this information should review or consult the primary data and information sources to ascertain the viability of the information for their purposes. The MSL provides these data in good faith and in no event, shall be liable for any incorrect results or analysis, any lost profits and special, indirect or consequential damages to any party, arising out of or in connection with the use or the inability to use the data or the services provided. The MSL makes these data and services available as a convenience to the public, and for no other purpose. The MSL reserves the right to change or revise published data and/or services at any time.

A	B	C	D	E	F	G	H	I	J	K	L	M	N	O	P	Q
8	Practice Code	Practice Name	Practice Component	Unit	Payment Rate per Unit	Unit Quantity By Year					Notes					Estimated Payment
9						Year 1	Year 2	Year 3	Year 4	Year 5						
10	382	Fence	Barbed or Smooth Wire	Foot	\$ 3.31	3,960.0										\$ 13,107.60
11	614	Watering Facility	Permanent Drinking with Storage, 500 to 1,000 Gallons	Gallon	\$ 4.27	1,000.0										\$ 4,270.00
12	516	Livestock Pipeline	Buried PVC, IPS, HDPE, PE	Foot	\$ 2.35	1,000.0										\$ 2,350.00
13	533	Pumping Plant	Photovoltaic-Powered Pump, <4 kW	Kilowatt	\$ 6,996.54	1.0										\$ 6,996.54
14	587	Structure for Water Control	Miscellaneous Structure, Small	Each	\$ 11,252.30	1.0										\$ 11,252.30
15																\$ -
16																\$ -
17																\$ -
18																\$ -
19																\$ -
20																\$ -
21																\$ -
22																\$ -
23																\$ -
24																\$ -
25																\$ -
26																\$ -
27																\$ -
28																\$ -
29																\$ -
30																\$ -
31																\$ -
32																\$ -
33																\$ -
34																\$ -
35																\$ -
36																\$ -
37																\$ -
38																\$ -
39																\$ -
40	Total Payment by Year:					\$ 37,976.44	\$ -	\$ -	\$ -	\$ -	Total:					\$ 37,976.44